

# Virtual Scavenger Hunt

Use the guided tour of the virtual exhibit Demo by Design found on the Museum Classroom page to answer this scavenger hunt.

1. Which Florida governor signed the law to preserve the Historic Capitol in 1978?



2. Look at Bill Thompson's drawings of the Capitol Complex. Describe three (3) differences in the options.

3. How do architects use models?

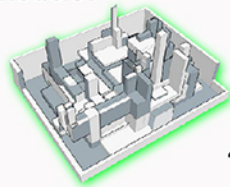

4. Why was the Historic Capitol restored to its 1902 look?

5. Which chamber is the ornamental plaster believed to be from?

6. What are some of the elements of the 1868 state seal? How are they the same or different from the current seal?



7. Which year did the Historic Capitol first have indoor plumbing?

8. Why were the colors of the Governor's Suite reproduction carpet chosen?

9. Where did the restoration team find the broken art glass fragments?

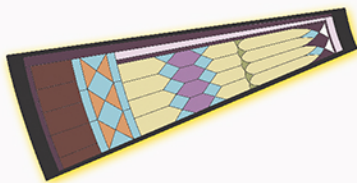

10. What object would you have saved from the restoration process and why?

